



# FLEXIAGENT

Market Leading, Independent Estate Agents



## Lytham Road

Southport, PR9 9UW

**Offers In Excess Of £140,000**

Flexi-Agent are delighted to present this TWO DOUBLE BEDROOM mid terrace house to the open market. Located close to the charming residential area of Churchtown, it's a short distance to Churchtown Village & the Botanic Gardens, close to excellent schools, has easy access in and out of Southport Town Centre via the A565 with a brilliant bus route service. Including many shops, restaurants and bars. Great opportunity for investors & first time buyers. Available for purchase with NO ONWARDS CHAIN.

The property briefly comprises of; spacious living room & kitchen, storage cupboard.

The first floor briefly comprises of; two double bedrooms & three piece bathroom.

Externally the property offers front drive parking, to the rear offers private courtyard & sun catching garden.

Viewings available upon request.

NO CHAIN  
Freehold  
Council tax band A  
EPC D

### Viewing

Please contact our Flexi Agent Southport Office on 01704 889455 if you wish to arrange a viewing appointment for this property or require further information.

- Two double bedroom
- Mid terrace
- NO CHAIN
- Spacious lounge & kitchen
- Three piece bathroom
- Private rear courtyard & sun catching garden
- Driveway parking
- Great opportunity for investors & first time buyers
- Short distance to Churchtown Village & the Botanic Gardens
- Viewings available upon request





Floor Plan

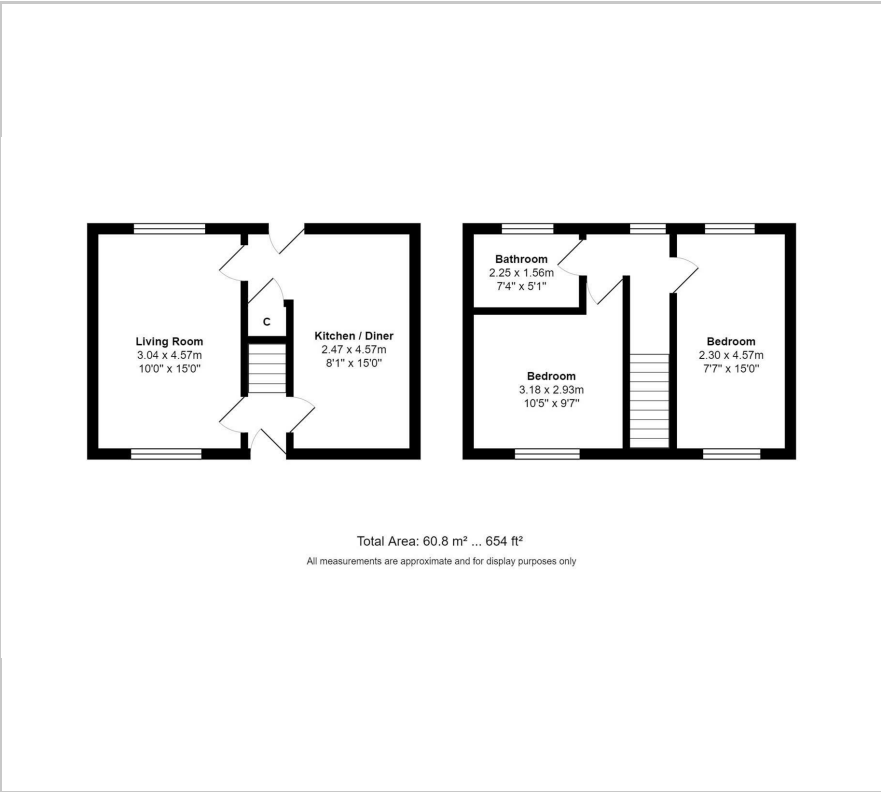

Area Map



Energy Efficiency Graph

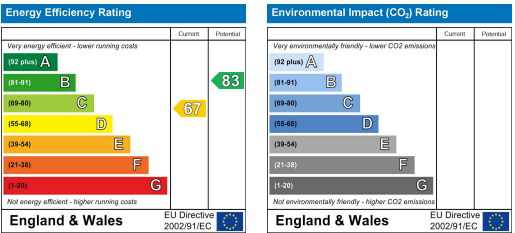

These particulars, whilst believed to be accurate are set out as a general outline only for guidance and do not constitute any part of an offer or contract. Intending purchasers should not rely on them as statements of representation of fact, but must satisfy themselves by inspection or otherwise as to their accuracy. No person in this firms employment has the authority to make or give any representation or warranty in respect of the property.